

# **AUTOMATIC CIRCLE WELDING**

---

## **ON PIPE AND PRESSURE VESSEL**

**No Hose or Cable Wrapup Regardless of Direction of Rotation. Welding Units.**  
Cypress Welding Equipment is guided by honesty, integrity and ethics in service to our customers and in all we do.



**USA**

# Cypress Makes The Weld Go Round

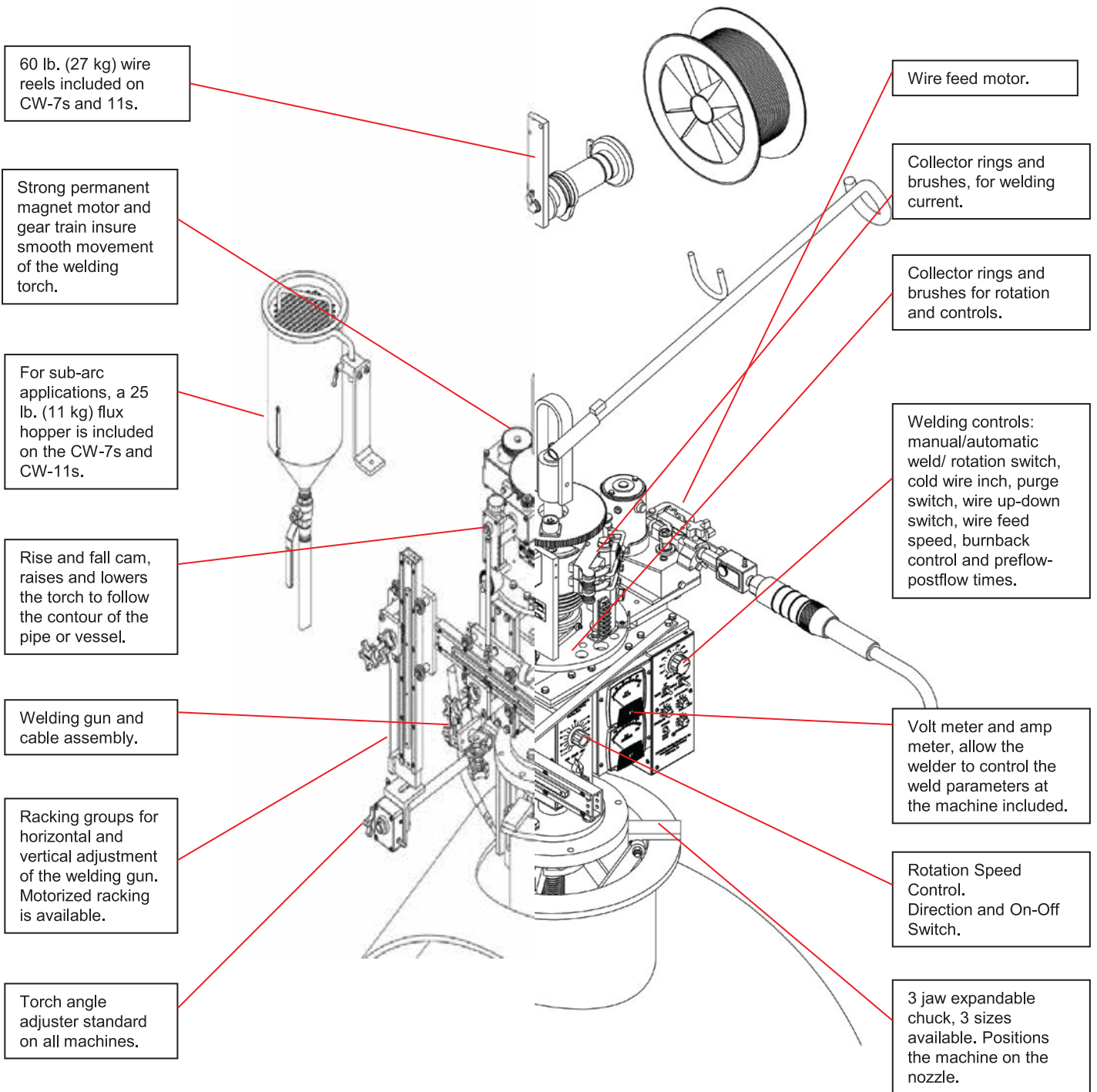

**Electric oscillators are available**

**No hose or cable wrap-up regardless of the direction of rotation**

# Circle Welders



**CW-7 Circle Welder (CWO-1700) is equipped for MIG, Flux Core and Sub Arc** welding on vessels and domed heads. The CW-7 has a working range of 6"-24" (152-610 mm) O.D. nozzles with no cable wrap up for multi-pass welding. This unit is capable of using welding wire sizes from .035"-3/32" (.8-2.4 mm). The machine is equipped as shown and will carry 60 lbs. (27 kg) spools of wire. The unit is complete with wire feeder, gun and cable assembly, flux hopper, wire reel and meter kit. Mounts on 3-jaw chuck. (See chart on page 5 for welding capacities).



**CW-11 Circle Welder (CWO-1100) is equipped** for MIG, Flux Core and Sub Arc welding on large vessels, domed heads and flat surfaces. The CW-11 has a working range of 10"-50" (254-1270 mm) O.D. nozzles with no cable wrap up for multi-pass welding. Remote control of amps and volts. The unit is capable of using welding wire diameters from .035"-3/32" (.8-3.0mm)



**CW-18 Circle Welder (CWO-1800) is designed for welding of nozzles into** vessels or domed heads utilizing SUB-ARC. The CW-18 mounts on a 3-Jaw Chuck welding diameter 6" to 50" (152-1270 mm) O.D. It is capable of using welding wire diameters 3/32-7/32" (2.4- 5.6 mm).

## Circle Welder Capacities

Model	Process Capabilities	Welding Diameter	Welding Wire Size	Rotation Speeds	Rise and Fall Cam	Rating amps	Standard Equipment
<b>CW-7 CWO-1700</b>	MIG/MAG, FCAW, SAW	6-24" (150-600mm)	.035-3/32" (.8-2.4mm)	2-2.2 rpm	0-7" (0-175 mm)	500 amps 100% duty cycle	Burn back control, horizontal and vertical adjustment gun and cable.
<b>CW-11 CWO-1100</b>	MIG/MAG, FCAW, SAW	10-50" (254-1270 mm)	Solid wire .035-3/32" (.8-3.0mm)  Flux Cored Wire .068-120" (1.7-3.0mm)	2-2.2 rpm	0-7" (0-175 mm)	500 amp CO 2 400 amp mixed gases 60% duty cycle	Burn back control, horizontal and vertical adjustment gun and cable
<b>CW-18 CWO-1800</b>	SAW	10-50" (254-1270 mm)	Solid Wire 3/32-7/32" (2.4-5.6 mm)	2-2.2 rpm	0-7" (0-175 mm)	1200 amps 60% duty cycle	Burn back control, horizontal and vertical adjustment gun and cable

# Circle Welders

Flux Recovery System installed on a CW-11.



**CWO-2020-AP-Submerged Arc Flux recovery system.**  
Continuously removes and recycles all unused flux compatible with CW-7, CW-11 and CW-18



**3-Jaw Expandable Chuck**  
Mounts and automatically centers the Circle Welder on nozzles with or without flanges. For use with all circle welders.

PAR NO.	FOR NOZZLE I.D.s	WEIGHT
CWO-3661	8"-16" (204-405 mm)	36 lbs. (16 kgs)
CWO-3662	10"-24" (255-610 mm)	51 lbs. (23 kgs)
CWO-3663	24"-42" (610-1065 mm)	64 lbs. (29 kgs)

## Accessories

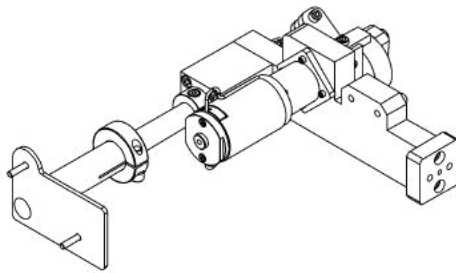

**CWO-1645 Torch Weaver**  
Provides a pendulum-type motion to the gun for weave welding. The speed and stroke of oscillation are adjustable.

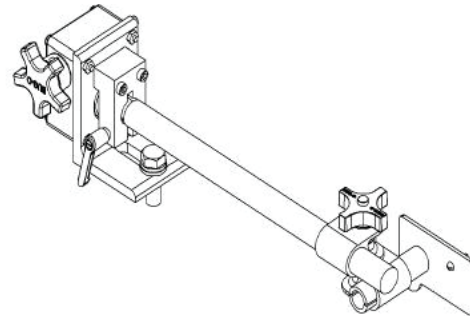

**CWO-3023-1 Torch Angle Adjuster**  
Allows the operator to adjust the angle of the gun precisely, without unclamping the holding devise.

